



MATERIALS LAYOUT

GENERAL NOTES

1. THIS DRAWING IS TO BE READ IN CONJUNCTION WITH ALL RELEVANT DOCUMENTS AND SPECIFICATIONS.
2. THE WORKS INDICATED ON THIS DRAWING HAVE, AS FAR AS IS REASONABLY PRACTICABLE, BEEN DESIGNED TO MEET THE REQUIREMENTS OF THE CONSTRUCTION DESIGN AND MANAGEMENT REGULATIONS. THOSE RESPONSIBLE FOR CONSTRUCTING THE WORKS MUST ALSO ENSURE THAT THE REQUIREMENTS OF THESE REGULATIONS ARE MET BEFORE PUTTING THE NECESSARY WORKS IN HAND.
3. THE CONTRACTOR IS ENTIRELY RESPONSIBLE FOR THE STABILITY OF THE WORKS AND ALL ADJACENT STRUCTURES AFFECTED BY THE WORKS AND SHALL DESIGN, INSTALL AND MAINTAIN ALL NECESSARY TEMPORARY WORKS TO COMPLY WITH THIS.
4. THESE WORKS ARE COVERED BY THE CDM REGULATIONS. ALL NECESSARY METHOD STATEMENTS ETC ARE TO BE PROVIDED TO THE PLANNING SUPERVISOR PRIOR TO THE COMMENCEMENT OF WORKS.
5. ALL DIMENSIONS AND DETAILS RELATING TO THE EXISTING BUILDING AND SITE TOPOGRAPHY ARE TAKEN FROM A SURVEY CONDUCTED BY OTHERS. NO RESPONSIBILITY CAN BE TAKEN FOR INACCURACIES IN THIS ORIGINAL SURVEY. THE CONTRACTOR IS TO CHECK ALL DIMENSIONS RELATING TO THE EXISTING FEATURES PRIOR TO CONSTRUCTION.
6. INFORMATION AND SETTING OUT ON THIS DRAWING IS BASED LARGELY ON INFORMATION TAKEN FROM CAD DRAWINGS PREPARED BY OTHERS AND GIVEN IN GOOD FAITH. NO RESPONSIBILITY CAN BE ACCEPTED FOR ERRORS RESULTING FROM INACCURACIES IN THESE ORIGINAL DRAWINGS.

EXTERNAL WORKS:

1. CONSTRUCTION DETAILS SHOWN ON THIS DRAWING HAVE BEEN BASED UPON A CBR VALUE FOR THE SUBGRADE OF 3% TO BE CONFIRMED ON SITE. REFER TO SPECIFICATION REGARDING PREPARATION OF SUBGRADE AND REMOVAL OF SOFT SPOTS. REFER TO THE ENGINEER FOR INSTRUCTIONS IF THE QUALITY OF THE SUBGRADE DOES NOT APPEAR TO MEET THIS REQUIREMENT.
2. UNLESS SPECIFICALLY NOTED, REFER TO THE ARCHITECT'S DRAWINGS FOR FULL DETAILS OF MANUFACTURER, COLOUR AND LAYING PATTERN FOR CONCRETE BLOCK AND FLAG PAVING.
3. ALL PRECAST CONCRETE KERBS TO BE HYDRAULICALLY PRESSED AND TO BE TO BS 7263-3.
4. ALL CONCRETE BEDDINGS AND HAUNCHES TO KERBS AND DRAINAGE CHANNELS TO BE GRADE ST2.
5. DOWELS TO BACKS OF KERB HAUNCHING MAY BE OMITTED IF HAUNCHING IS CAST MONOLITHICALLY WITH BASE - REFER TO SPECIFICATION.
6. THIS SITE HAS SuDs FEATURES. ALL EXTERNAL WORKS TO BE CONSTRUCTED ON THIS SITE TO BE IN ACCORDANCE WITH THE HADBOOK FOR CONSTRUCTION OF SuDs:2007 BY CIRIA

MATERIALS KEY

- IMPERMEABLE BLACK TARMAC TO PARKING BAYS UP TO 2M PERIMETER ZONE FROM BUILDING
- PERMEABLE BLACK TARMAC TO MAIN ACCESS ROAD
- BRETT ALPHA FLOW PERMEABLE BLOCK PAVING TO FRONT PERIMETER - CHARCOAL
- NATURAL RIVEN SLAB TO PATIOS & ENTRANCE FOOTPATHS
- AREAS OF SOFT LANDSCAPING. REFER TO LANDSCAPE ARCHITECT'S DRAWINGS AND SPECIFICATION.
- AREAS OF SHINGLE INFILL STRIPS
- CONCRETE KERBS, TYPES AS FOLLOWS:
HB2 - HALF BATTER TO BS EN 1339:2003
BN - BULLNOSE TO BS EN 1339:2003
EFT - FLAT-TOP EDGING TO BS EN 1339:2003
DR1 - DROPPER KERB, RIGHT HAND, TO BS EN 1339:2003
DL1 - DROPPER KERB, LEFT HAND, TO BS EN 1339:2003
- INDICATES 3 ROWS OF GRANITE SETTS
- INDICATES BOLLARDS
- INDICATES 1200mm HIGH METAL RAILINGS
- BOX HEDGE IN PLANTERS (REFER TO LANDSCAPE DRAWING FOR DETAILS)
- INDICATES 4m HIGH COLUMN LIGHT (DUSK TILL DAWN SENSOR)
- INDICATES HIGH LEVEL EXTERNAL WALL LIGHT (PIR + DUSK TILL DAWN SENSOR)
- INDICATES STRIP LIGHT TO SOFFIT OF UNDER CROFT (PIR + DUSK TILL DAWN SENSOR)
- FLOOD VOID WITH STEEL GRILL

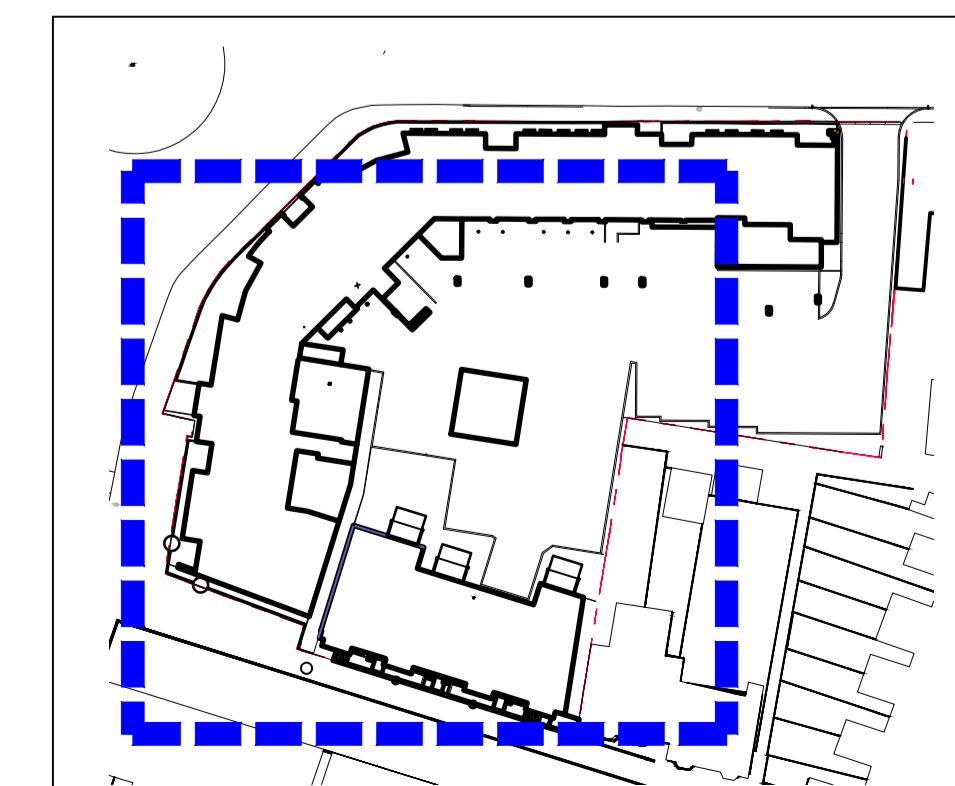

KEY PLAN

Consultant

RHA
CHARTERED CIVIL AND STRUCTURAL ENGINEERS
 Unit 14 Weston Barns, Hitchin Road, Weston, Herts SG4 7AX
 Telephone: 01438 350933 • www.richardhutton.co.uk

Contractor to check all dimensions on site. Do not scale. Report any discrepancies to Engineer immediately. Read in conjunction with all other relevant drawings and specifications. © This drawing is copyright. Do not reproduce in whole or part without written consent.

© This drawing is the copyright of SHANLY HOMES
 All dimensions and levels must be checked on site and verified prior to construction

Notes

Rev.	Description	Date
F	PLANTER AND LIGHTING POSITION ERROR CORRECTED.	18.05.18
E	ISSUED FOR CONSTRUCTION. PLOT 1-6 BALCONY POSTS INDICATED. PEDESTRIAN GATE ADDED BETWEEN PLOTS. LIGHTING POSITION ADJUSTED. LEVELS INDICATED.	01.05.18
D	LAYOUT UPDATED TO SUIT ARCHITECTS LATEST DRAWINGS. PARKING BAY POSITIONS REVISED. GAS METER CUPBOARDS UPDATED. BOLLARDS UPDATED TO REAR OF BAYS 15 & 16. FRONT ENTRANCE TO PLOTS 1-6 UPDATED. CRANE BASE LOCATION INDICATED.	12.02.18
C	MATERIALS UPDATED TO INCLUDE PLANTERS & LIGHTING COLUMNS & VENTED GAS METER ENCLOSURES. MATERIAL SPECIFICATION UPDATED.	31.10.17
B	MATERIALS UPDATED TO INCLUDE AREA OF PERMEABLE SURFACE.	06.10.17
A	LAYOUT UPDATED TO SUIT COMMENTS. BUILDING LEVELS DROPPED. KEY UPDATED.	08.09.17
-	INITIAL ISSUE	25.08.17

Project

**DAYLA DRINKS
 AYLESBURY**

Drawing Title

**MATERIALS LAYOUT
 SHEET 1**

**SHANLY
 HOMES**

'Sorbon', Aylesbury End, Beaconsfield, Buckinghamshire, HP9 1LW
 Tel: 01494 671331
 Fax: 01494 676417
 DX 34507 Beaconsfield

Drawn By: LP	Date: AUG 17
Scale: 1:100	A1
Drawing No. 1303 - 103.1	Revision F